

- NOTES:
- FOR SITE CLEARANCE REFER TO DRAWING No. 70007437-03-SC-01
 - FOR ROAD MARKINGS REFER TO DRAWING No. 70007437-03-RM-01
 - FOR ALIGNMENT OF NEW DUCTING REFER TO TFL SIGNALS DRAWING No PRO/01/000078/06

- KEY (Cont)
- PROPOSED PUSH BUTTON
 - PROPOSED PRIMARY SIGNAL
 - PROPOSED SECONDARY SIGNAL
 - PROPOSED PEDESTRIAN SIGNAL WITH COUNTDOWN
 - IBUS AERIAL

- KEY
- PROPOSED 750x600x65mm FIBRE REINFORCED CONCRETE PAVERS LAID ON 50mm SAND/CEMENT BED AND 150mm C16/20 CONCRETE BASE
 - PROPOSED 50mm HRA 35/14F SURF DES PMB WTR2 WITH 10/14 PCC SURFACE COURSE
 - PROPOSED 50mm HRA 35/14F SURF DES PMB WTR2 WITH 10/14 PCC SURFACE COURSE AND DARK GREY HFS TYPE 1 TREATMENT
 - EXISTING GRANITE SETTS TO BE TAKEN UP AND RELAID ON 50mm SAND/CEMENT BED, ON 200mm C20 WET LEAN CONCRETE BASE, MECHANICALLY GROUTED
 - BUFF COLOURED SURFACING, BAUXITE HIGH FRICTION SURFACING TYPE 1 TREATMENT
 - PROPOSED 150x300mm GRANITE KERB ON 150mm C16/20 WET LEAN CONCRETE
 - PROPOSED 150x300mm FLUSH GRANITE KERB WITH DROPPER LAID ON 150mm C16/20 WET LEAN CONCRETE WITH 6mm UPSTAND (MAX)
 - PROPOSED 300x200mm GRANITE KERB ON 150mm C16/20 WET LEAN CONCRETE
 - PROPOSED 300x200mm FLUSH GRANITE KERB WITH DROPPER LAID ON 150mm C16/20 WET LEAN CONCRETE WITH 6mm UPSTAND (MAX)
 - PROPOSED 'MARSHALLS' TIMRI 1500 BESPOKE DEMOUNTABLE REFUGE ISLAND
 - PROPOSED PRIMROSE YELLOW LINE MARKING
 - PROPOSED WHITE LINE MARKING
 - PROPOSED PEDESTRIAN CROSSING STUD MARKINGS
 - PROPOSED NEW UTILITY RECESSED COVER
 - EXISTING SERVICE COVER TO BE ADJUSTED IN LEVEL AS NECESSARY
 - PROPOSED 400x400x65mm GREY PRECAST CONCRETE TACTILE PAVING ON 50mm SAND/CEMENT BED, ON 100mm C16/20 CONCRETE BASE
 - IGP PROPOSED INTERNALLY ILLUMINATED SOLAR POWERED BOLLARD
 - PROPOSED CYCLE-FRIENDLY GULLY COVER TO BE INSTALLED ON EXISTING GULLY FRAME
 - EXISTING GULLYGRATE AND FRAME TO BE ADJUSTED IN LEVEL AS NECESSARY
 - EXISTING SMOKE OUTLET/PRIVATE FORECOURT PAVING TO BE RETAINED
 - EXISTING CONTROLLER BOX TO REMAIN
 - EXISTING 300x200mm GRANITE KERB TO REMAIN
 - EXISTING LINE MARKING TO REMAIN
 - EXISTING LAMP COLUMN TO REMAIN
 - EXISTING GULLY TO REMAIN

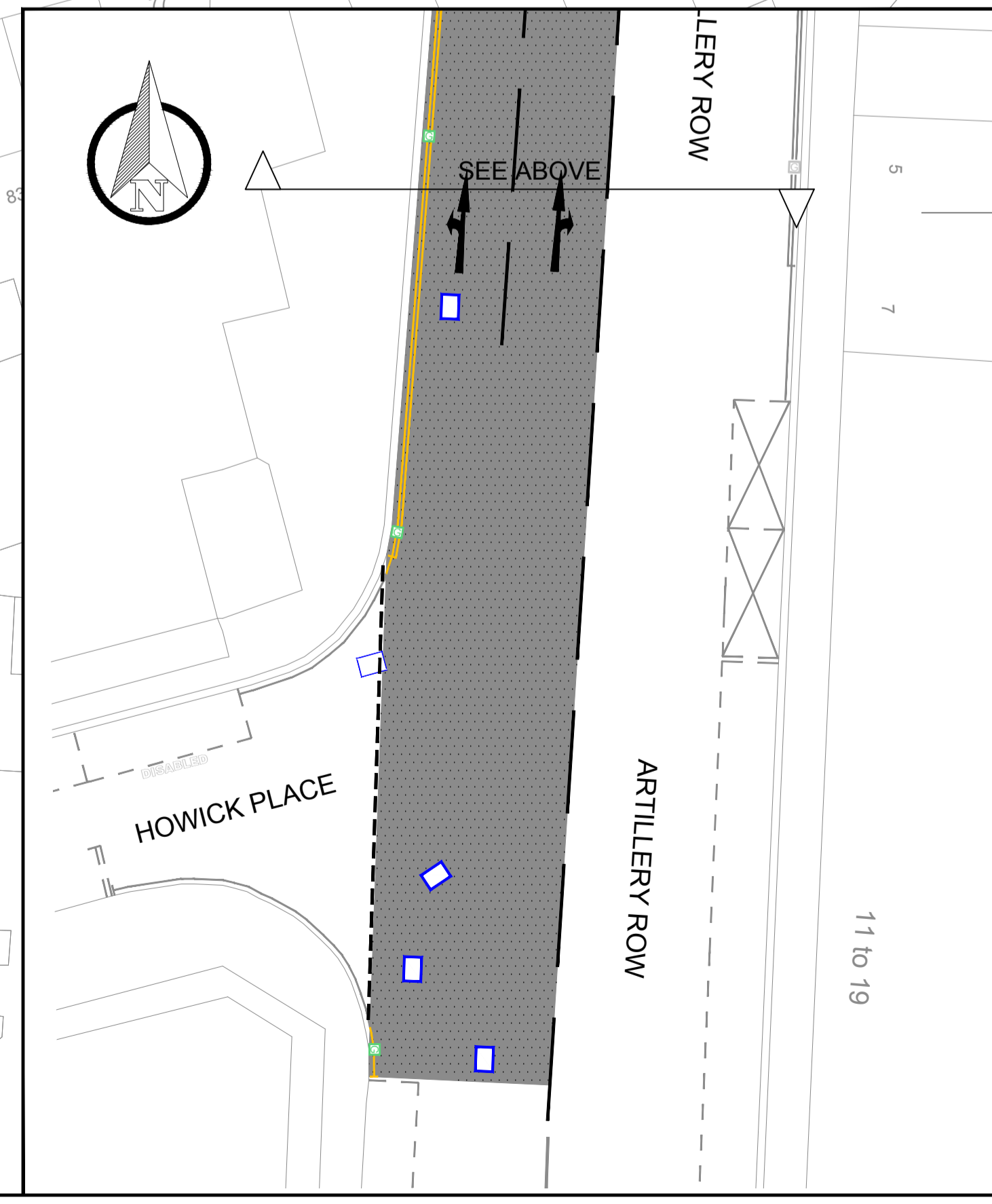
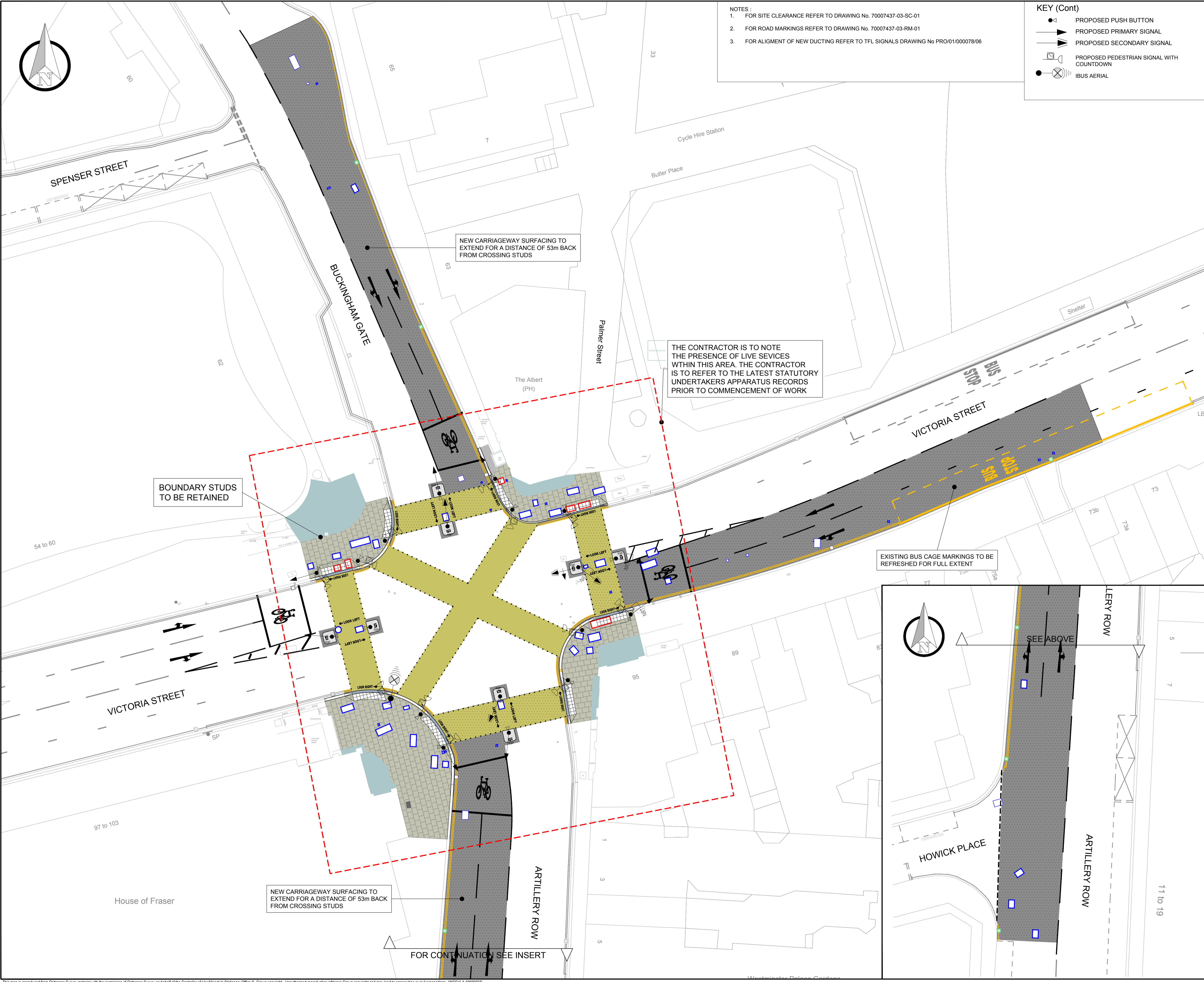

REV	DATE	BY	DESCRIPTION	CHK	APP
A	10.09.2016	PAD	INITIAL ISSUE		

DRAWING STATUS: **DETAILED DESIGN**

25 Mandala Way, London, SE1 1SZ
www.fconway.co.uk www.wspgroup.com

CLIENT: **City of Westminster**

PROJECT: **LOCAL SAFETY SCHEMES
VICTORIA STREET / ARTILLERY ROW**

TITLE: **GENERAL ARRANGEMENT**

SCALE @ A1	DATE	DESIGNOR/RAWN	CHECKED	APPROVED	SHEET
1:200	09-09-2016	JOO/PAD	PF	PF	A1
JOB No:	FMC PROJECT No:	BREF/D88 No:			
70007437	VVWESA1350	BR 21923			
DRAWING No:					REV
70007437-03-GA-01					A

C:\Users\joc\Documents\Projects\Westminster\70007437-03-GA-01 Rev A.dwg 12 Sep 2016 11:25:58